

Hi-Tech Fasteners, Inc.

4940 Winchester Blvd.

Frederick, MD, 21703, US

Phone: 301-831-1277

Fax: 301-831-8296

Toll-free: 800-466-1940

Email: sales@hitechfasteners.com

Website: http://www.hitechfasteners.com

Item # KFB3-632-8ET**QUOTE****For spacing or stacking P.C. boards. Special shank is flared to increase pushout resistance. Thread sizes #4, #6 and M3, M4.**

Can satisfy component-to-board, board-to-board, and board-to-chassis production fastening needs using less attachment hardware.

Broaching Fasteners

- **PEM** broaching fasteners can be utilized with all types of PC boards, as well as with acrylic and polycarbonate components. They install simply, quickly, and permanently for secure and reliable attachment. Their use eliminates the need for washers, lock washers, nuts, and other excess hardware.
- The PEM family of broaching fasteners includes broaching nuts (Types KF2 and KFS2) with permanent threads for board mounting or component attachment; threaded or unthreaded standoffs (Types KFE and KFSE) for stacking or spacing and flare mounted standoffs (Type KFB3) for greater pullout performance; threaded studs (Type KFH) for use as solderable connectors or as permanently mounted mechanical fasteners with external threads; all-metal standoffs (Type KSSB) featuring a spring action to hold a PC board securely without screws or threaded hardware; self-expanding FOILGARD® fasteners (Type KPS6) used in plated thru-holes in multi-layer PC Boards; and one-piece board-mount screw assemblies (Type PFK) with captive screws for easy mounting and removal of PC boards.

Quantity Discount Available.

Request Quote for orders less than 1000 or 5000, depending on fastener type.

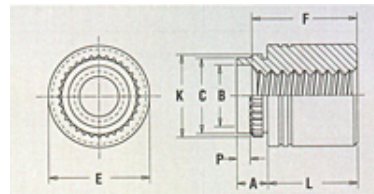
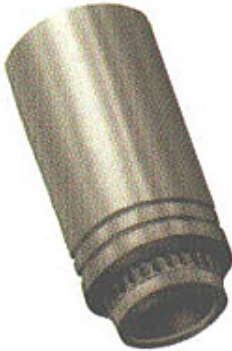
**MATERIAL & FINISH SPECIFICATIONS**

Threads ¹	Internal, ANSI B1.12B/ANSI/ASME B1.13M 6H
Fastener Materials	CDA-353 Brass
Standard Finishes	Electro-Plated Bright Tin ASTM BS45, Class "B" With Preservative Coating
For Use in Sheet Hardness	65 or Less on the Rockwell "B" Scale PC Board

¹ For plated studs, Class 2A/6g, the maximum major and pitch diameter, after plating, may equal basic sizes and can be gauged to Class 3A/4h