

REV.	DESCRIPTION	DATE
A	NEW DRAWING	10/20/2005
B	Added dimensions	3/3/2006

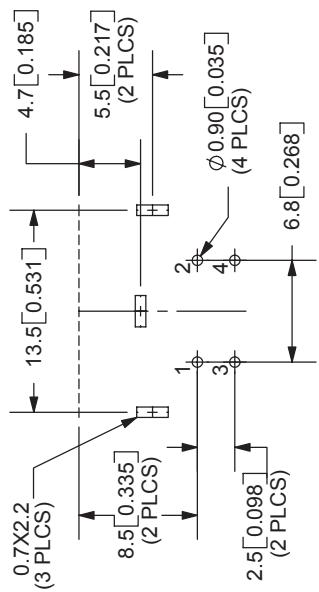

SPECIFICATIONS:
RATING: 12V DC @ 2A; 100V AC @ 1A
INSULATION RESISTANCE: 10M OHMS MIN; 250V DC
VOLTAGE WITHSTAND: 250V AC R.M.S. FOR 1 MINUTE
CONTACT RESISTANCE: 30m OHMS MAX
INSERTION FORCE: 5KG MAX
WITHDRAWAL FORCE: 0.8KG~3.5KG
LIFE: 5,000 CYCLES
OPERATING TEMP: -40° ~ +85°C

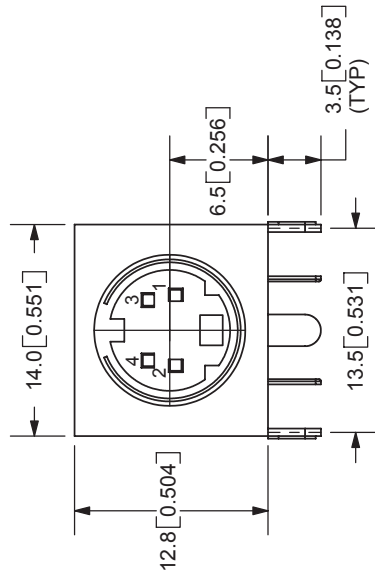
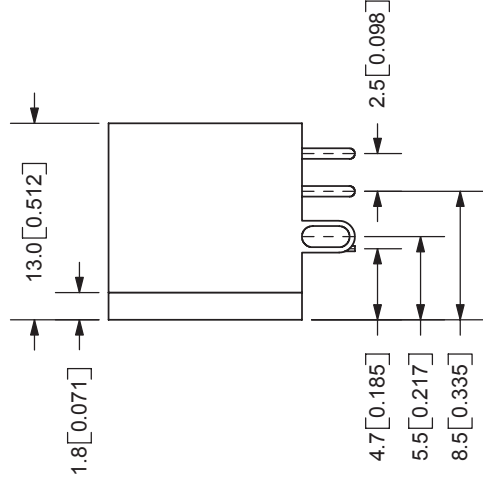
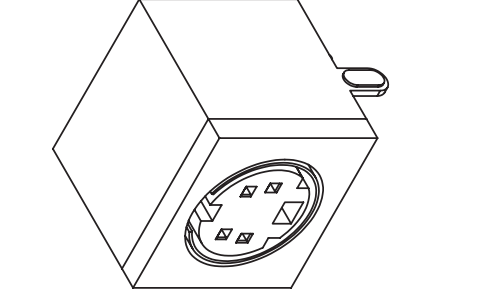

TOLERANCE:
±0.2mm UNLESS OTHERWISE
SPECIFIED



20050 SW 112th Ave.
Tualatin, OR 97062
Phone: 503-643-4899
800-275-4899
Fax: 503-372-1266
Website: www.cui.com

TITLE: MINIATURE CIRCULAR DIN CONNECTOR	REV: B															
PART NO: MD-40SM	UNITS: MM [INCHES]															
DRAWN BY: ZRJ	APPROVED BY:															
	SCALE: 2:1															
<table border="1"> <thead> <tr> <th>SHIELDING PLATE</th> <th>MATERIAL</th> <th>PLATING</th> </tr> </thead> <tbody> <tr> <td>CONTACT TERMINALS (1-4)</td> <td>Steel</td> <td>Tin</td> </tr> <tr> <td>EARTH TERMINALS</td> <td>Phosphor Bronze</td> <td>Silver</td> </tr> <tr> <td>HOUSING</td> <td>Brass</td> <td>Tin</td> </tr> <tr> <td></td> <td>PBT</td> <td></td> </tr> </tbody> </table>		SHIELDING PLATE	MATERIAL	PLATING	CONTACT TERMINALS (1-4)	Steel	Tin	EARTH TERMINALS	Phosphor Bronze	Silver	HOUSING	Brass	Tin		PBT	
SHIELDING PLATE	MATERIAL	PLATING														
CONTACT TERMINALS (1-4)	Steel	Tin														
EARTH TERMINALS	Phosphor Bronze	Silver														
HOUSING	Brass	Tin														
	PBT															

PC FILE NAME: MD-40SM

COPYRIGHT 2006 BY CUI INC.